

banana bike LT

Thank you for choosing Banana Bike. A Banana Bike is a fantastic first bike and a great way for your child to learn the basics of biking, learning to balance and steer whilst having massive fun!

If you have any questions or issues, please email us at: hello@banana-bike.com

Some parts may be preassembled on the forks / frame



- A & B - Bearings (Pair)
- C - Flat Plastic Washer
- D - Domed Plastic Washer
- E - Forks
- F - Handlebars
- G - Aluminium Hex Clamp
- H - Seat & Seat Post Unit
- I - Spanner
- J - Hex Key
- K - Quick Release Clamp
- L - Frame
- M - Wheels



Attach the Forks & Handlebars to the Frame

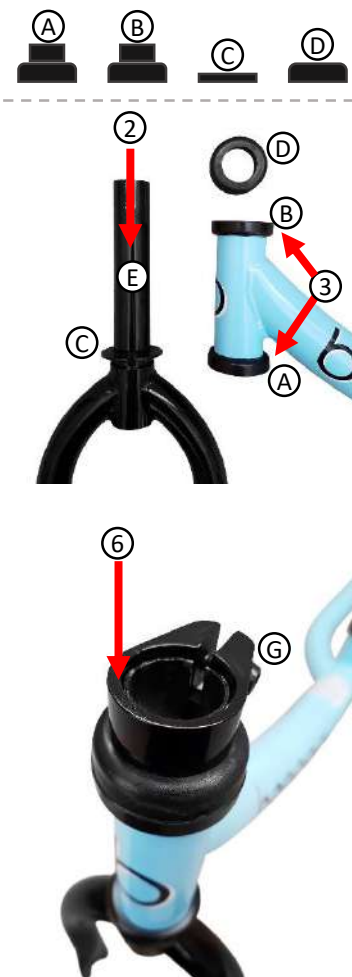

1. Lay the forks and frame on the floor
2. Slide the flat plastic washer (C) over the fork shaft (E)
3. Slide the bearings (A & B) into the frame head tube
4. Slide the forks through the bearings and frame head tube
5. Slide the domed bearing (D) over the forks to rest on the top of the bearing (B)

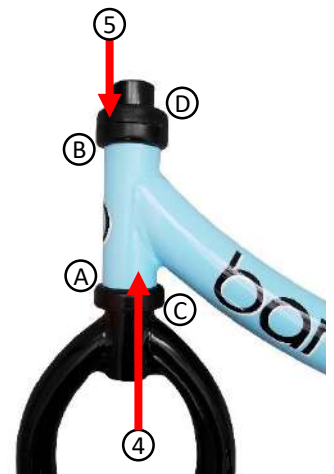

6. Stand the bike up on its forks. Slide the aluminium hex clamp (G) over the fork shaft
7. Slide the handlebars (F) into the fork shaft, ensure handlebars are inserted past the minimum insertion mark
8. Applying a small amount of downwards pressure to the hex clamp (G), tighten the hex clamp (G), using the hex tool (J) until it starts to grip the forks and handlebars
9. Then ensure the forks and handlebars are parallel
10. Tighten the aluminium hex clamp until handlebars are secure (Important!)
11. The handlebars and forks should now be fully joined and have a smooth turning action

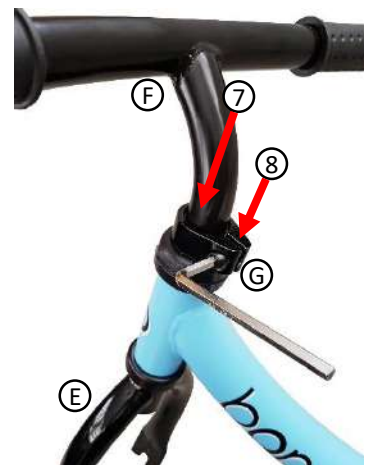

Fit the Seat

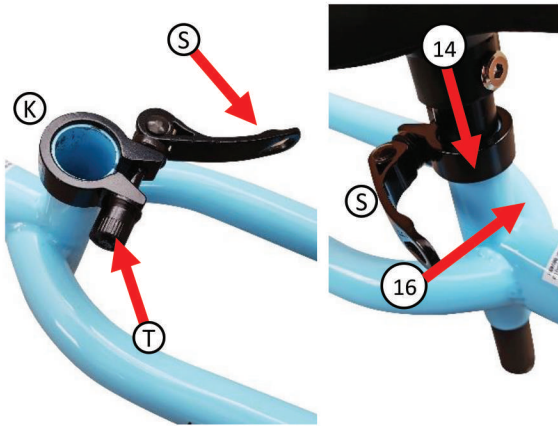

12. Fit the quick release clamp (K) over the top of frame.
13. With the lever open (S), lightly tighten the clamp (T) until the arm no longer hangs down
14. Slide the seat post into the frame until the seat is at the required height. Please note the post minimum insertion mark.
15. Ensure the seat is aligned with the frame.
16. Close the clamp arm and test the seat is tight (Important!)
17. If the seat moves, open the arm, tighten the clamp further with fingers or hex key, then reclose arm.

Attach the Wheels to the Frame

18. Turn the bike over with the handlebars on the floor.
19. To fit the front wheel, remove the dome nut (O) and hooked safety clip (N) from each end of the axle.
20. Slide the axle into place between the forks.
21. The spacers (P) and inner nuts (R) sit between the wheel bearing and the forks.
22. Slide a hooked safety clip (N) over each end of the axle and hook them through the hole in the frame.
23. Fully tighten the dome nuts (O) (Important!).
24. Repeat with rear wheel.
25. Regularly check that the dome nuts are tight. (Important!)

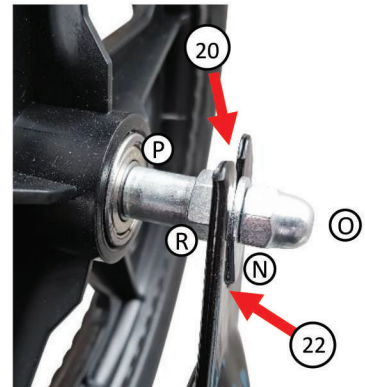

Congratulations! The bike is now ready to ride, this is where the fun starts!

If you have any questions, issues or feedback please email us at:
hello@banana-bike.com or visit <http://www.banana-bike.com/contact>

Stay Safe

1. **WARNING!** Maximum rider weight: 25 kg
2. Accessories bag contains small parts. **CHOKING HAZARD!**
3. **IMPORTANT!** Before riding, please check that the seat, wheels and handlebars are tight and secure, failure to do so could result in an accident.
4. Adult assembly required.
5. For the child's personal safety, always use safety equipment such as Helmet, Elbow pads, Knee Pads, and Gloves. Always wear shoes when riding.
6. Don't transport passengers. Ride on smooth paved flat surfaces without any traffic. Not for use on public roads.
7. Do not ride at dusk, at night, or at times of limited visibility and unfit weather.
8. Replace worn or broken parts immediately.

Maintenance Guidelines for Your Bike

Maintenance and use of the bikes

- a) Make sure to teach your child how to stop the bike when necessary.
 - When riding the bike, the child must use his/her feet to stop the bike.
 - When riding the bike in downhill, the little rider will have to use his/her feet for stopping.
- b) Adjust the height for your child's comfort and joy when riding the bike.

Please see 14 (Page 2 Fit the Seat) for adjusting bike height & size.
- c) The bike is suitable for cleaning with water and soap. Wipe with a dry cloth afterwards.
- d) Storing the bike in a dry place will ensure that it serves many years.

Never leave it in the rain or snow when the adventure is over.
- e) Banana bikes are made easy to ride, but the assembly of the bike, as simple as it is, must be done by an adult. When assembling done, make sure that all the knobs and screws are properly tightened, and the seat is fixed firmly. Do the check before each ride.

International

DE - Eine ausführliche
Anleitung finden Sie
unter:
banana-bike.de

FR - Pour des
instructions complètes
s'il vous plaît visitez:
banana-bike.fr

ES - Para obtener
instrucciones
completas, visite:
banana-bike.es

IT - Per le istruzioni
complete, visitare il
sito:
banana-bike.it

